

外形尺寸 / Dimensions

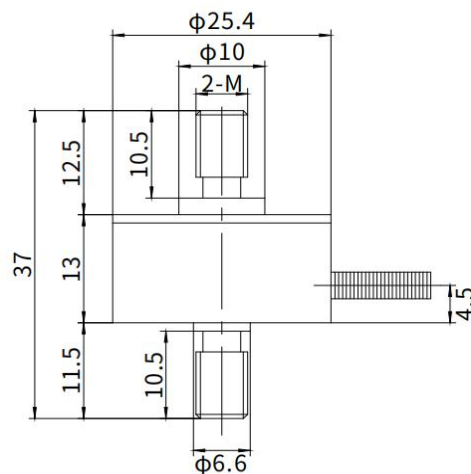
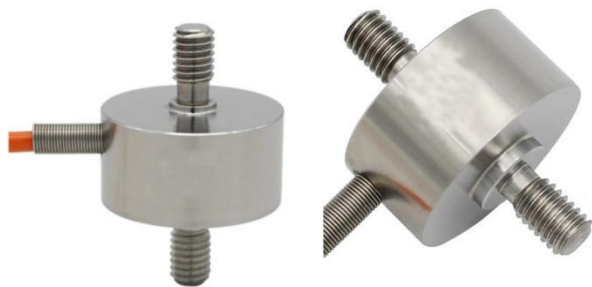

特点和用途 / Features & Applications

- 体积小，拉压双向，易于安装
- 适用于汽车压装，自动化组装，3C 产品测试，新能源产品组装，医疗检测，机器人领域，模具组装及其他工业测试，自动化设备领域
- ❖ Small volume , double pull pressure , easy to install
- ❖ Suitable for automotive compression , automatic assembly , 3 C product testing , new energy product assembly , medical bolt ,Robo tics , mold assembly and

other industrial testing , automation equipment fields

选型表 / Features & Applications

量程范围 Cap	M
1~50kg	M5
60~100kg	M6
200~500kg	M8

技术参数 / Technical Parameters

量 程 Capacity	1~500kg	绝缘阻抗 Insulation	$\geq 5000M\Omega / 100V\ DC$
额定输出 Rated output	$1.0\sim 1.5\pm 10\%mV / V$	温度补偿范围 Compensated temp range	$-10^{\circ}C \sim 60^{\circ}C$
滞 后 Hysteresis	0.1 % R.O.	工作温度范围 temp range	$-20^{\circ}C \sim 80^{\circ}C$
重 复 性 Repeatability	0.1% R.O.	推荐激励电压 Recommended excitation	5~10V DC
非 线 性 Non-linearity	0.3% R.O.	安全载荷 Safe overload	150% R.C.
零点输出 Zero balance	$\pm 2\%$ R.O.	最大负载 Ultimate overload	200% R.C.
蠕变 Creep	0.2% R.O.	响应频率 Response frequency	10KHZ
零点温漂 Temp.effect on zero	0.1 % R.O. / $10^{\circ}C$	材质 Material	不锈钢
灵敏度温漂 Temp.effect on output	0.1% R.O. / $^{\circ}10C$	电缆线规格 Cable Specifications	$\varnothing 3*2m$
输入阻抗 Input impedance	350 Ω	张缆极限拉力 Cable Ultimate pull	10kg
输出阻抗 Out impedance	350 Ω	TEDS	可选

接线图 / Schematic Wiring Diagram

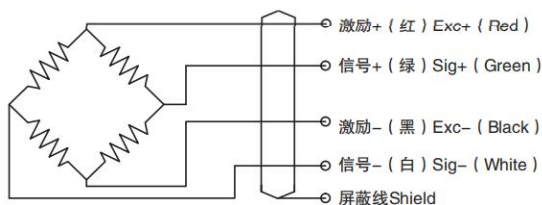

注：屏蔽线不与弹性体相连。

Note: Cable shield is not connected to element.

受力方式 / Force Direction

